

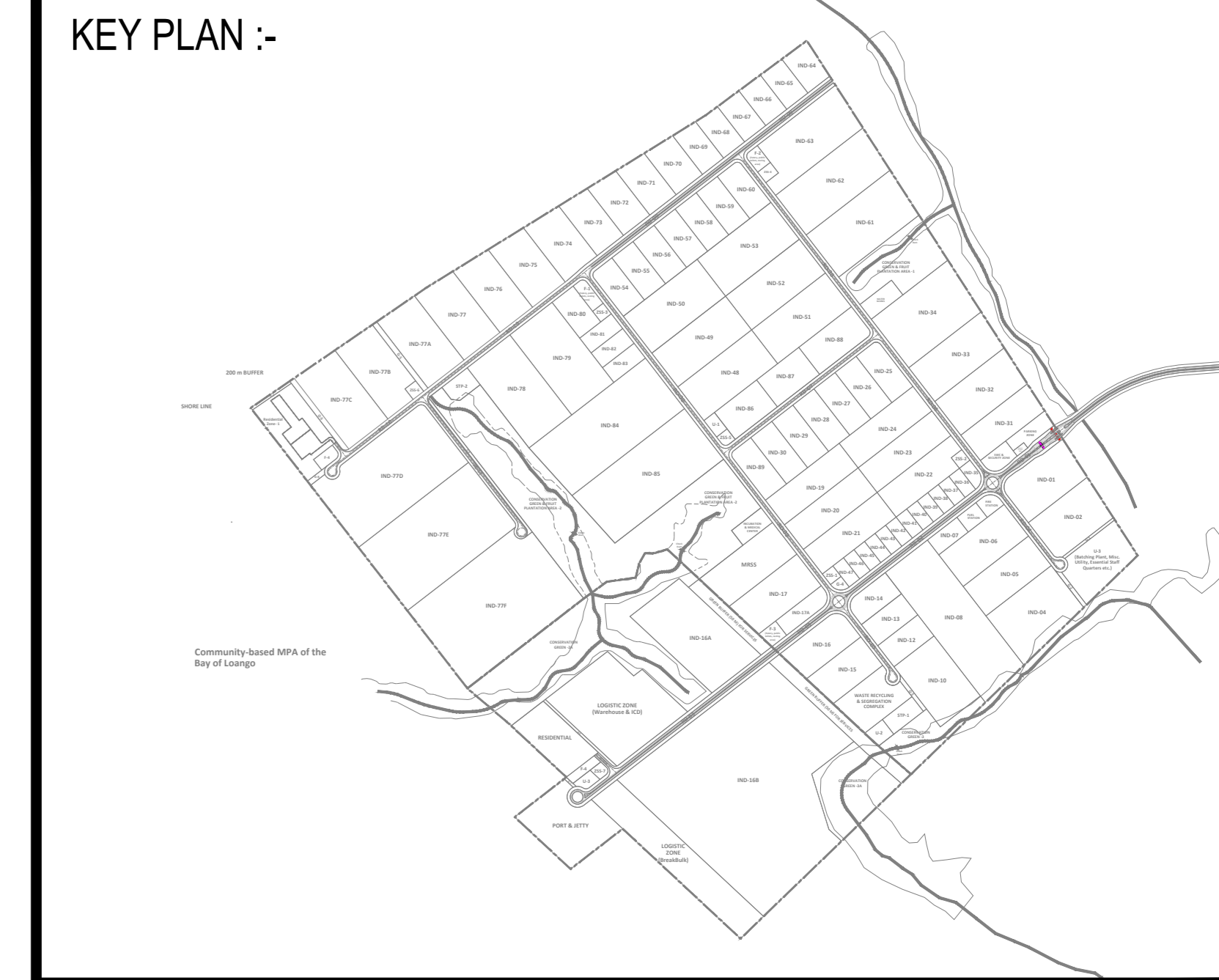

Community-based MPA of the Bay of Loango



- NOTES:-**
- 1 ALL DIMENSION IN METERS.
  - 2 DIMENSIONS ARE TO BE READ AND NOT MEASURED.
  - 3 DRAWING IS TO BE READ IN CONJUNCTION WITH RELEVANT STR./SERVICES DRAWING.
  - 4 ANY DISCREPANCY IN DRAWING IS TO BE REPORTED TO ARISE DESIGN TEAM IMMEDIATELY.

**LEGEND:-**

	180 Dia. Pipe		GLSR
	250 Dia. Pipe		Future Pump House
	400 Dia. Pipe		HSC
	Sluice Valve (SV)		Fire Hydrant (FH)
	Scour Valve (ScV)		End Cap
	Future GLSR		Air Release Valve -40 mm dia Double acting
	Filtration Unit		Bulk Flow Meter (BFM)

All Pipe of HDPE PE100 PN10 or above grade

PIC SEZ, ROC - WATER SUPPLY NETWORK LENGTHS		
S.No.	Diameter (mm)	Length (m)
1	180	1,318
<b>Total</b>		<b>1,318</b>

Project Name: POINT NOIRE SEZ, ROC

Project Company: Plateformes Industrielles du Congo Pointe-Noire

Design: ARISE IIP   
A-702-707, Tower A, Digital Greens, Golf Course Extension, Gurugram, Haryana India. www.ariseliip.com

Drawing Title: WATER SUPPLY NETWORK

CONCEPT DESIGN	DESIGN DEVELOPMENT	TENDER DRAWING	FOR CONSTRUCTION	AS BUILT
----------------	--------------------	----------------	------------------	----------

Drawing Number: ARISE IIP/PICP/PN/TD/WS/NP-01A

Number of Revisions: 02	Drawing Scale: 1:2500
Date: 08.01.2024	Sheet Size: A2

REVISION					
Rev.No.	DESCRIPTION	Designed By	Verified By	Approved By	Date
02	Updated as per Revised Master Plan				08.01.2024